

RPWB

Truck weighing load cell **20, 25, 30, 50 tf**

FEATURES



CE

Robust design and easy installation
 Strong against shock or side force
 Surge protected
 Rotation protected
 Protection class IP68

DIMENSIONS

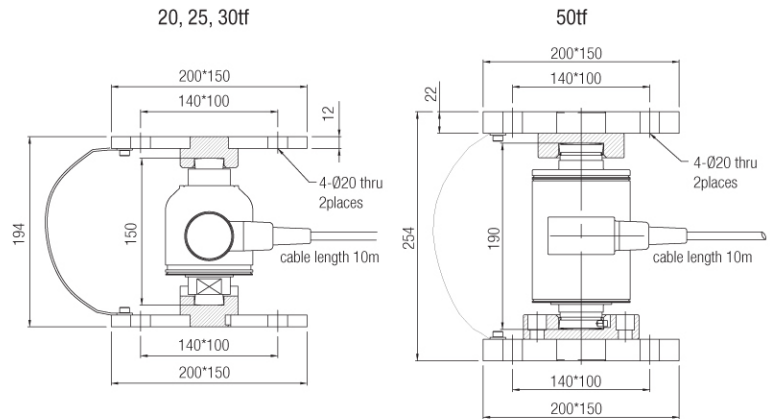

050-2222-9933

Material

Stainless steel

Cable

Braided shield 4-wire round cable with PVC-jacke

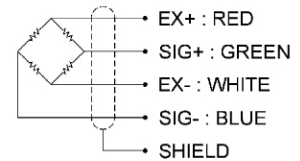

SPECIFICATIONS

Max. Capacity	tf	20, 25, 30, 50	
Rated output	mV/V	2.0 ± 0.005	
Zero balance	mV/V	0 ± 0.03	
Accuracy class		D3	C3
Combined error	%	0.03	0.02
Repeatability	%	0.02	0.01
Creep(30min.)	%	0.03	0.017
Temperature effec on			
Zero value	%/°C	0.03	0.014
Output value	%/°C	0.03	0.011
Excitation			
Recommended	V	10	
Maximum	V	15	
Resistance			
Input	Ω	350 ± 3.5	
Output	Ω	350 ± 3.5	
Insulation	MΩ	>2,000@50V DC	
Compensated temp. range	°C	-10 ~ +40	
Operating temp. range	°C	-20 ~ +80	