

SBLC

Tension Load Cell **500 kgf, 1, 2, 3, 5 tf**

Background of development

- 1) Easy installation of loadcell
- 2) Convenient assembly of shackle and loadcell
- 3) Measurement for every industrial tensile load
- 4) Needs for the choice of various capacities

DIMENSIONS

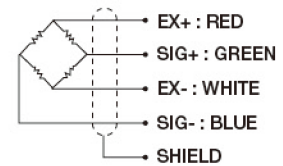
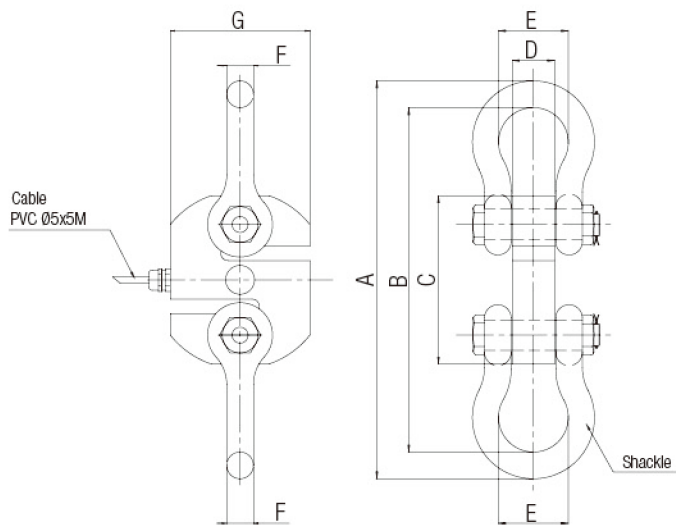

Capacity	A	B	C	D	E	F	G	Shackle
500kgf, 1tf	240	220	120	15	26	10	78	BB(3/8")
2, 3, 5tf	330.8	286.4	140	35	58	22.2	116	BB(7/8")

SPECIFICATIONS

Max. Capacity		tf	500kgf, 1, 2, 3, 5tf
Rated output		mV/V	2.0 Nominal
Zero balance		mV/V	0 ± 0.2
Combined error		%RO	0.03
Repeatability		%RO	0.01
Creep(30min.)		%RO	0.03
Temperature effect on			
	Zero value	%RO/10°C	0.028
	Output value	%RO/10°C	0.014
Excitation			
	Recommended	V	10
	Maximum	V	15
Resistance			
	Input	Ω	400 ± 50
	Output	Ω	350 ± 3.5
	Insulation	MΩ	> 2,000
Compensated temp. range		°C	-10 ~ +40
Operating temp. range		°C	-20 ~ +80